



Angle Insulator Roller - SPP

Part No. SPP-1E-AR

This unique angle insulator roller has 2 adjustable angle rollers and 2 support rollers that allow the conductor to be brought in at final installation height and adjusted to any required angle alongside the insulator.

The conductor is fully enclosed at all times during the stringing operation and cannot fall out. When stringing & tensioning is complete, the locking pins are opened and the roller removed, leaving the conductor in its correct position on the insulator.

The sealed bearing assists smooth running of the conductor.

The clamps are specially treated with rubber so as not to damage the insulator.

The roller fits all styles of ceramic insulators. See below table for suitable neck diameters



SCAN or CLICK for application video

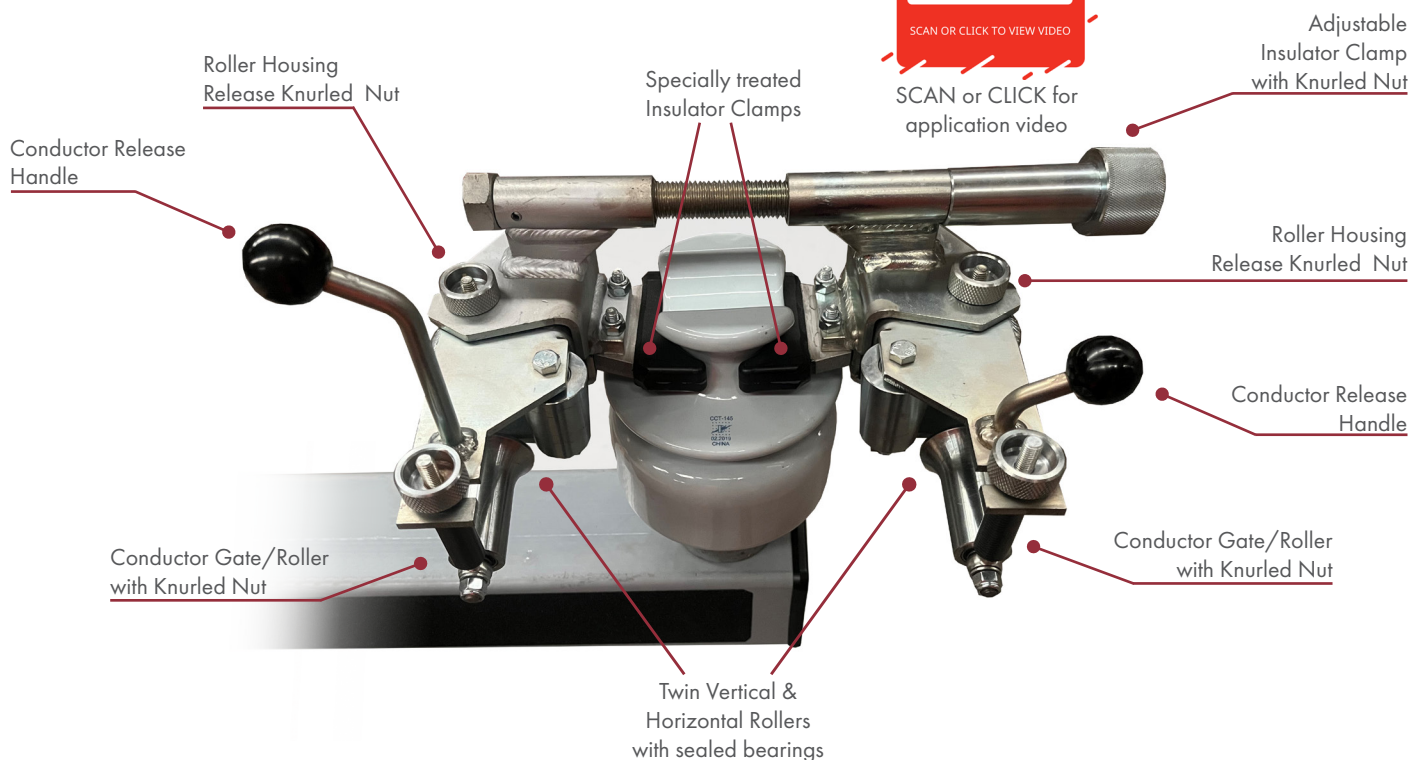

Specifications

Part No.	Insulator Neck diameter range		Max Conductor Diameter (mm)	Conductor Type	WLL (kg)	Weight (kg)
	Min (mm)	Max (mm)				
SPP-1E-AR	46	86	50	AL/CU/ACSR/ST*/ABC/CCT	300	7.4

*Steel Conductor will increase wear and may reduce service life of vertical & horizontal rollers



Angle Insulator Roller - SPP

Part No. SPP-1E-AR



1 Place the roller on the insulator, with the twin horizontal & vertical rollers facing the angle of the conductor.

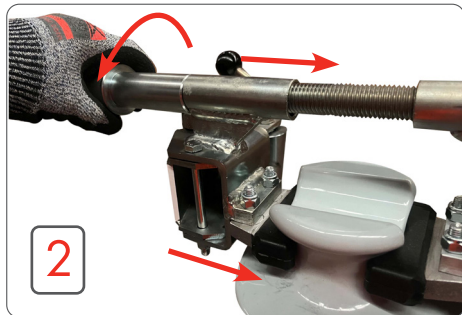

2 Turn the adjustable Insulator knurled knob to tighten the clamps around the insulator neck

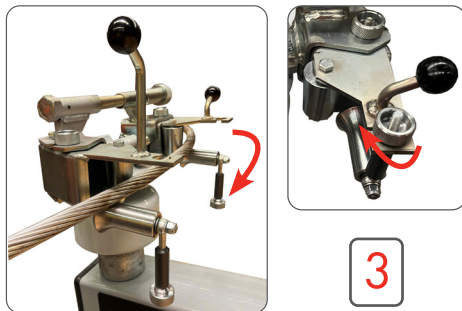

3 Undo the two knurled nut to release the conductor roller gate and drop down so the conductor or rope can be installed.

Close the roller gates so the conductor or rope is captured and can't fall out.

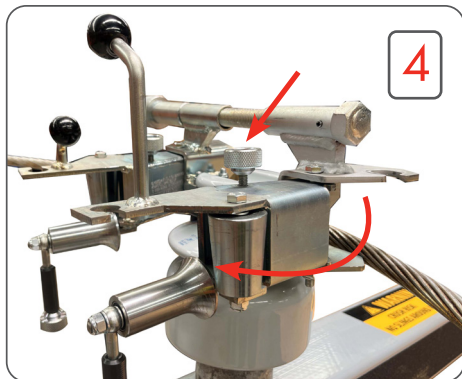

4 Complete the stringing and tensioning process, open the roller gates as in step 3.

Undo the roller housing knurled nuts to release the roller housings.

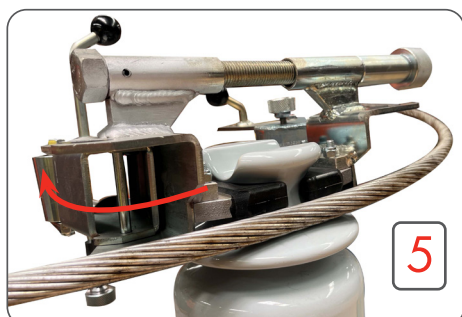

5 Spin the roller housings 180° away from the conductor and remove the complete roller, leaving the conductor in place on the insulator, ready for tying off.

Tie the conductor off as required



SCAN OR CLICK TO VIEW VIDEO

SCAN or CLICK for application video

