

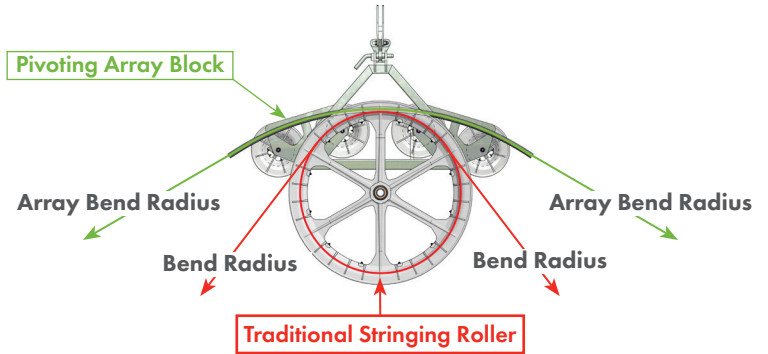

Stringing Rollers, Swivels, Joints & Socks - TESMEC

TESMEC

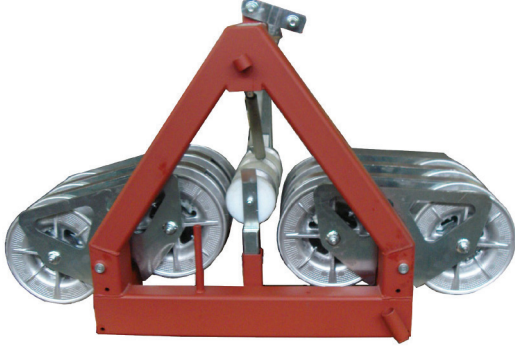

Pivoting Array Blocks - TESMEC

Array blocks are used for conductors with large bending radius.

- **Lightweight - Dimension:**
Vertical dimension is less than half of the height of a standard pulley
- **Easy Handling & Transportation:**
The compact design allows easy handling and prevents damaging during the transportation
- Refer page Transmission Stringing Section of the TEN catalogue for detailed information



Stringing Blocks

With more than 60 years of job-site use and thanks to a deep knowledge of job-site needs, Tesmec offers:

- Top quality at a competitive price
- Tailor made solutions
- 5 different materials and types for lining
- Available tandem and for helicopter stringing version on every standard model



- **No diameter limitation:**
Double pivoting frame allows it to move according to the line geometry by adjusting up to horizontal position, for an infinite bending radius
- **Special Sectors:**
Manufactured with anti wear material, tested and released in cooperation with Milan Politecnico
- **Integrated Earthing Device:**
Earthing device (if requested) is integrated into the frame, to prevent any possible impact or damaging during transport
- **Matchable with Standard Block:**
Groove 68 mm and groove 95 mm as per standard pulley are both available
- **Fully Compatible:**
Headboards, swivels, ropes, cover joints and all other equipment used for standard pulleys are fully compatible with array blocks
- **High Center of Gravity:**
Easier positioning at angles due to the centre

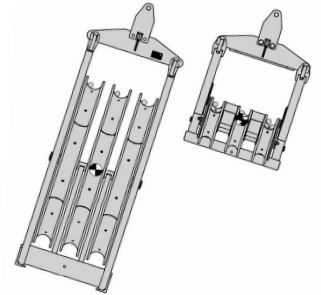

Earthing devices

Safety certified

In accordance with IEC TR 61328, Tesmec Earthing Devices are suitable for fault currents, lightning strikes and induced voltage rated at 20A for 20 cycles.

Several tests certified earthing devices properties. Available for drain current in equipotential system and for induced current.

Aluminium sectors with bearing conductive grease are also available as a special solution.



Comprehensive range of Rollers available. Contact TEN for further information.



Fixed Joint - TESMEC

Part No. GFT Series



- Highly tensile forged galvanised steel
- Compact shape for bull wheel grooves

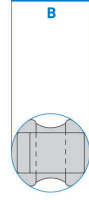
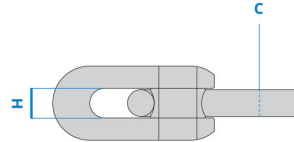
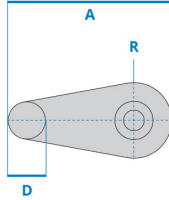

| Part No. | Dimensions (mm) | | | | | | Working Load (kN) | Wt (kg) |
|----------|-----------------|----|-------|------|----|------|-------------------|---------|
| | A | B | C max | D | H | R | | |
| GFT001 | 59 | 28 | 10 | 15 | 11 | 11 | 23 | 0.3 |
| GFT010 | 74 | 40 | 13 | 19.5 | 14 | 15 | 37 | 0.33 |
| GFT020 | 91 | 48 | 16 | 20 | 19 | 18 | 53 | 0.53 |
| GFT030 | 102 | 54 | 18 | 22 | 19 | 20 | 73 | 0.75 |
| GFT040 | 121 | 60 | 24 | 27 | 26 | 22 | 120 | 1.03 |
| GFT050 | 174 | 75 | 28 | 42 | 30 | 32 | 250 | 3.03 |
| GFT060 | 183 | 81 | 32 | 42 | 34 | 34.5 | 250 | 3.4 |

Swivel Joint - TESMEC

Part No. GGT Series

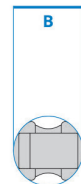
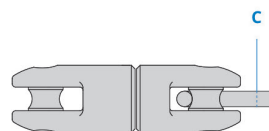
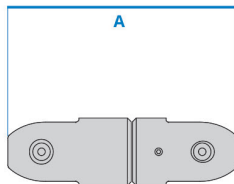

| Part No. | Dimensions (mm) | | | Working Load (kN) | Wt (kg) |
|----------|-----------------|-----|-------|-------------------|---------|
| | A | B | C max | | |
| GGT001 | 106 | 28 | 10 | 23 | 0.3 |
| GGT010 | 143 | 40 | 13 | 37 | 0.93 |
| GGT020 | 184 | 54 | 18 | 73 | 2.15 |
| GGT030 | 234 | 60 | 24 | 120 | 3.4 |
| GGT040 | 322 | 77 | 28 | 250 | 8.2 |
| GGT180 | 336 | 81 | 32 | 250 | 8.7 |
| GGT260 | 403 | 104 | 38 | 330 | 19.5 |



Heavy Duty Large Eye Conductor Socks - TESMEC

Part No. GCT Series

- Ideal for Transmission overhead work
- Suitable for Transmission & Distribution AL, CU & ST
- Colour coded plastic bands at ferrule to identify range and capacity
- Steel wires with protective finish and alloy ferrule
- Long mesh length provides additional gripping surface area
- Protective shoulders - protects the sock from sharp edges on the conductor during stringing
- Flexible & Reusable

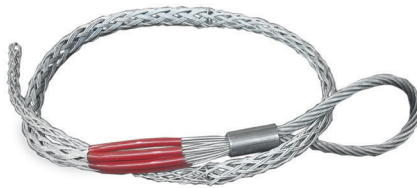
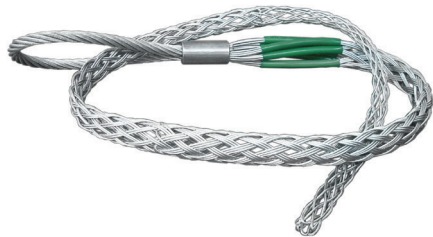

| Part No. | Suitable Swivel | Conductor OD Ø (mm) | Colour | UTS (kN) | Mesh Length (mm) | Wt (kg) |
|----------|-----------------|---------------------|--------|----------|------------------|---------|
| GCT001 | GGT001 | 8 - 17 | Yellow | 35 | 1100 | 0.7 |
| GCT010 | GGT010 | 17 - 29 | Red | 85 | 1360 | 1.3 |
| GCT020 | GGT020 | 29 - 38 | Green | 130 | 1470 | 2.1 |
| GCT030 | GGT020, GGT030 | 38 - 50 | Black | 180 | 1820 | 2.7 |

Heavy Duty Conductor Double Head Sock - TESMEC

Part No. GCT

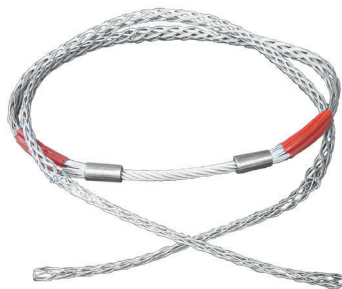

Scan or Click to View or Download Grip Inspection Selection & Application

| Part No. | Conductor OD Ø (mm) | Colour | UTS (kN) | OAL (mm) | Wt (kg) |
|----------|---------------------|--------|----------|----------|---------|
| GCT500 | 8 - 17 | Yellow | 35 | 2680 | 1.15 |
| GCT510 | 17 - 29 | Red | 85 | 3240 | 2.3 |
| GCT520 | 29 - 38 | Green | 130 | 3540 | 3.6 |
| GCT530 | 38 - 50 | Black | 180 | 4240 | 4.8 |